

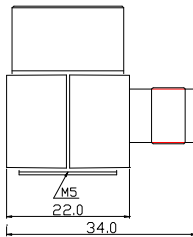

IEPE Industrial Application – TNC Output / Insulation Base

Model NTI-13220



DYNAMIC

Sensitivity $\pm 10\%$	-----	50 mV/g
Measurement Range	-----	± 100 g peak
Broadband Resolution	-----	0.0002 g rms
Amplitude Nonlinearity	-----	1 %
Frequency Range $\pm 5\%$	-----	0.5 – 5 kHz
$\pm 10\%$	-----	0.3 – 6 kHz
Resonance Frequency	-----	14 kHz
Transverse Sensitivity	-----	≤ 5 %

ELECTRICAL

Excitation Voltage	-----	18 - 30 VDC
Constant Current Excitation	-----	2 – 20 mA
Output Impedance	-----	≤ 100 Ω
Output Bias Voltage	-----	12 VDC
Spectral Noise (10 Hz)	-----	36 $\mu\text{g}/\sqrt{\text{Hz}}$
(100 Hz)	-----	12 $\mu\text{g}/\sqrt{\text{Hz}}$
(1000 Hz)	-----	9 $\mu\text{g}/\sqrt{\text{Hz}}$
Mounting Ground Insulation Resistance	-----	$\geq 1 \times 10^8$ Ω

ENVIRONMENT

Maximum Vibration	-----	800 g peak
Maximum Shock	-----	2000 g peak
Operation Temperature	-----	-40 to 248°F / -40 to 120°C
Sealing	-----	Welding
Base Strain Sensitivity	-----	0.0005 g/ μ strain

PHYSICAL

Sensing Element	-----	Ceramic / Shear
Housing Material	-----	Stainless Steel
Output Connector / Position	-----	TNC / Side
Mounting Thread	-----	M5
Weight	-----	75 gram

ACCESORIES SUPPLIED

- Ø 4.5 mm x 1 m Coaxial Cable with TNC / BNC Connectors
- M5-M5 Mounting Stud
- Calibration Certificate

Note: Mounting thread can be changed to English 10-32 thread by request.

